

Sample Floor Plan

A Floor Plan is a top view of a structure as seen if it is cut horizontally a few feet above the floor. One Floor Plan is required for every floor of the dwelling, which is affected by the construction. Each Floor plan shows the interior layout of the level in question as well as providing the Structural Framing information for the floor above. In the case of the top floor plan, the Roof Framing is shown instead.

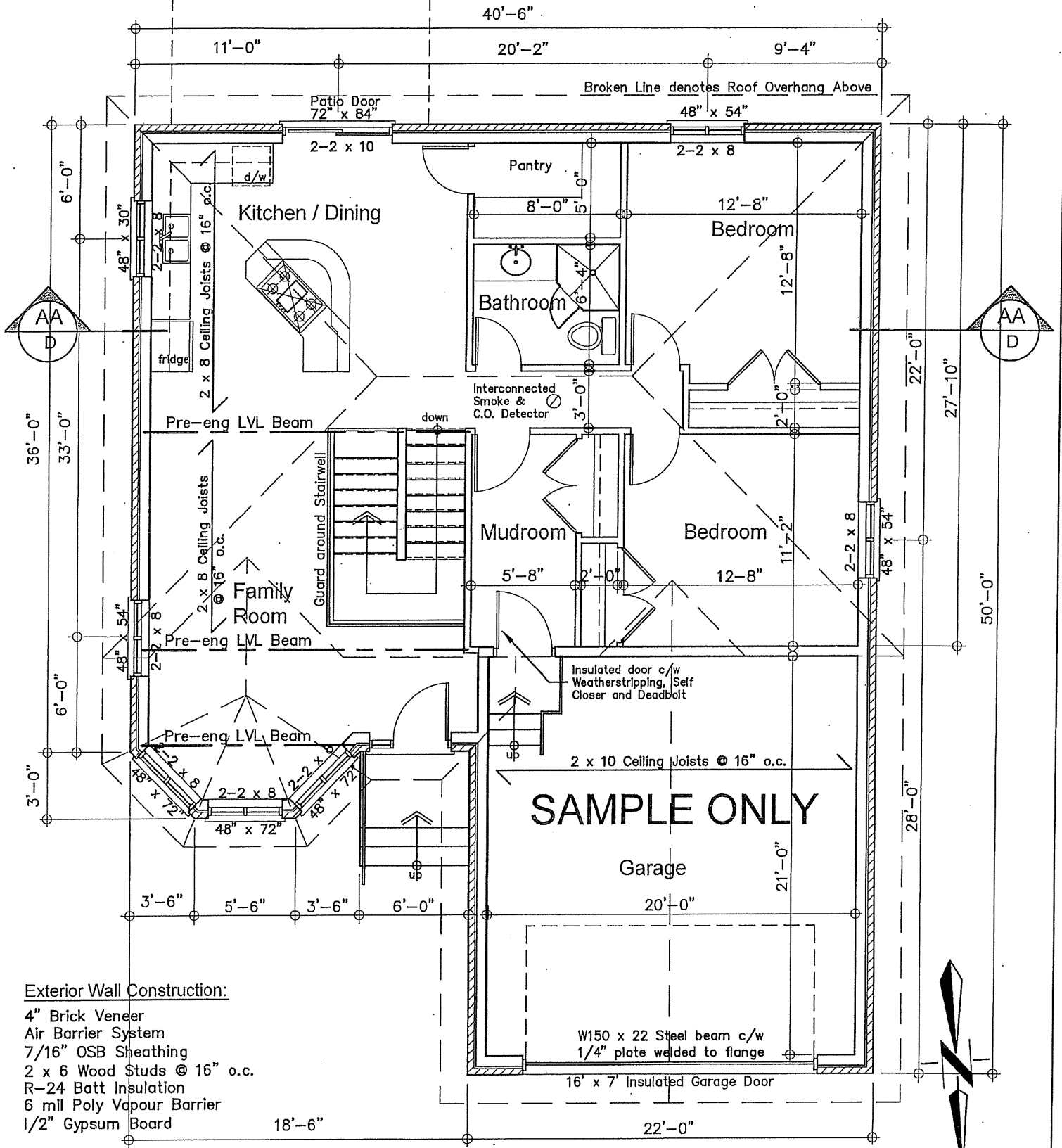

Exterior Wall Construction:

- 4" Brick Veneer
- Air Barrier System
- 7/16" OSB Sheathing
- 2 x 6 Wood Studs @ 16" o.c.
- R-24 Batt Insulation
- 6 mil Poly Vapour Barrier
- 1/2" Gypsum Board

Interior Partitions:

- 1/2" Gypsum Board
- 2 x 4 Wood Studs @ 16" o.c. (Unless noted otherwise)
- 1/2" Gypsum Board

Main Floor Plan

Scale: 1/4" = 1'-0"