

Sample Site Plan



A Site Plan identifies Buildings and other features in relation to Property Boundaries. The Site Plan should identify your Existing Dwelling, other Existing Structures (ie. Garages, Sheds, Decks) and Proposed Additions or New Structures.

Most or all the information required for a Site Plan can be found on your Property Survey. You may have received a Survey when you purchased your Home.

The following information should be shown on a Site Plan:

- Title and Scale
- Legal Description
- Street Name
- North Arrow
- Property Lines with Dimensions
- Setbacks(distance) to all Property Lines from all Existing and Proposed Structures
- Proposed Construction(shaded areas)
- Overall building Dimensions, Lot Coverage, New & Existing Building Areas of all Bldgs.
- Right Of Way Easements.

In some instances a complete Property Survey may be sufficient. Check with staff at our counter.

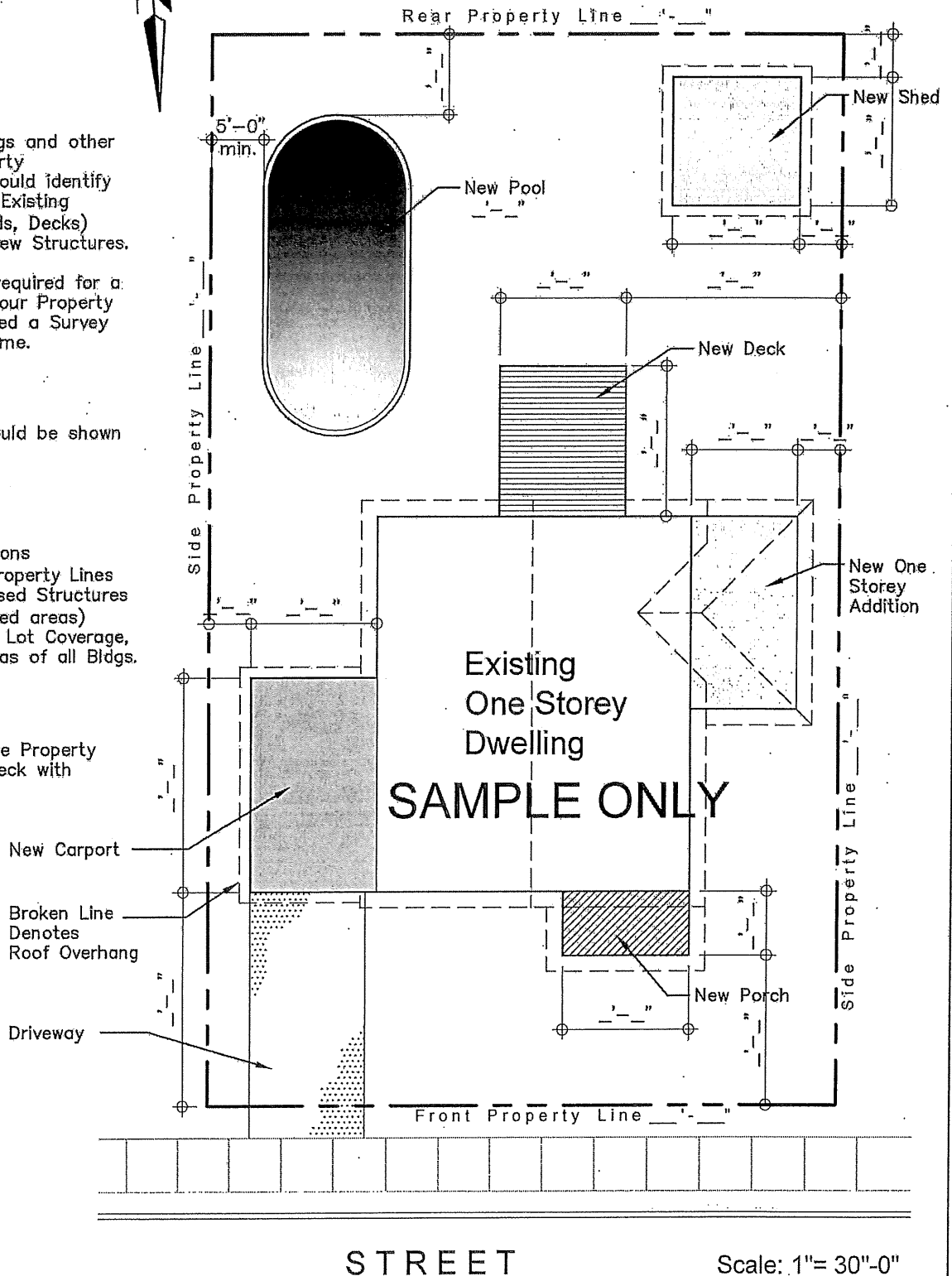

Note:

- 1.) Do Not Submit this Sample Drawing as part of your Drawing Package.
- 2.) Plans Submitted for Review are to be drawn at a Recognized Scale ie. 1" = 20'-0" or 1:100(metric)

Legend:

— — — Denotes information that is Required on your SITE PLAN. This information consists of Setbacks, Dimensions and Other Elements.