

# Zoning Bylaw for the CORPORATION OF THE TOWNSHIP OF BALDWIN

## Schedule 'A' Land Use Plan

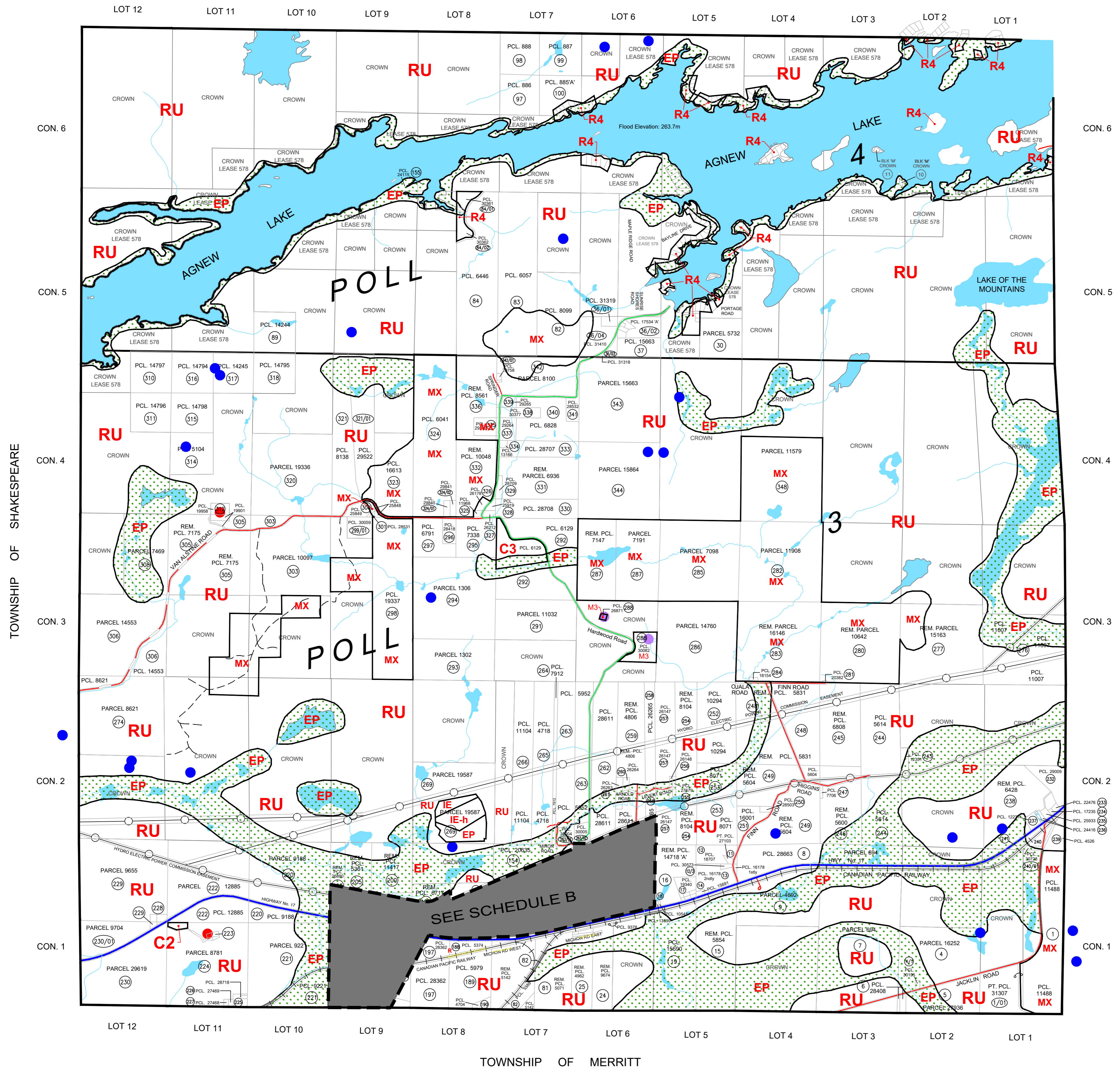

SCALE 1:20,000  
October 1, 2018

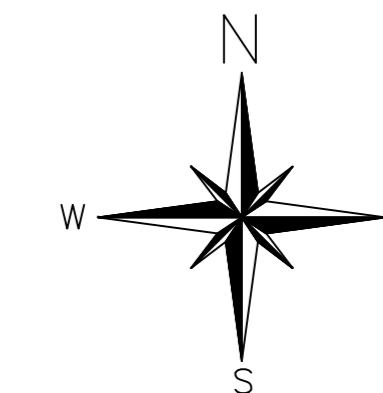

### Legend

#### Residential Zones

- R1 Residential Low Density
- R2 Residential Multiple
- R3 Residential Mobile Home
- R4 Seasonal and Waterfront Residential

#### Commercial Zones

- C1 General Commercial
- C2 Highway Commercial
- C3 Resort Commercial

#### Industrial Zones

- M1 Light Industrial
- M2 Rural Industrial
- M3 Waste Management
- MX Aggregate Extractive
- MIN Mining

#### Other Zones

- RU Rural Zone
- I Institutional
- OS Open Space
- EP Environmental Protection

#### Community Facilities

- Community/Fire Hall
- Parks and Playgrounds

#### 5. Transportation and Communication

- Provincial Highways
- Township Road
- Township Road (Seasonally Maintained)
- Private Road
- Railway Line
- Hydro Transmission Corridor
- Communication Towers

#### 6. Natural and Human-Made Hazards

- Mine Hazard
- Flood Elevation - Agnew Lake - 263.7m G.S.C.

# Zoning Bylaw for the CORPORATION OF THE TOWNSHIP OF BALDWIN

## Schedule 'B' Land Use Plan



SCALE  
1:5000  
0 0.5 1.0 km  
October 1, 2018

### Legend

#### Residential Zones

- R1 Residential Low Density
- R2 Residential Multiple
- R3 Residential Mobile Home
- R4 Seasonal and Waterfront Residential

#### Commercial Zones

- C1 General Commercial
- C2 Highway Commercial
- C3 Resort Commercial

#### Industrial Zones

- M1 Light Industrial
- M2 Rural Industrial
- M3 Waste Management
- MX Aggregate Extractive
- MIN Mining

#### Other Zones

- R Rural Zone
- I Institutional
- OS Open Space
- EP Environmental Protection

#### Community Facilities

- Community/Fire Hall
- Parks and Playgrounds
- 5. Transportation and Communication
  - Provincial Highways
  - Township Road
  - Township Road (Seasonally Maintained)
  - Private Road
  - Railway Line
  - Hydro Transmission Corridor
  - Communication Towers

#### 6. Natural and Human-Made Hazards

- Mine Hazard
- Flood Elevation - Agnew Lake - 263.7m G.S.C.

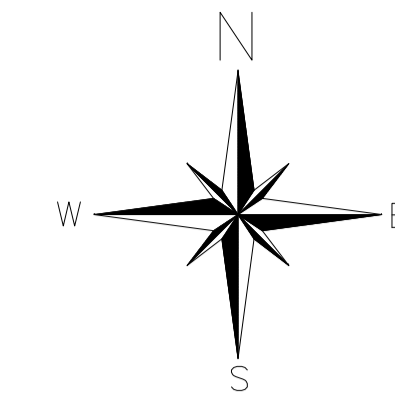
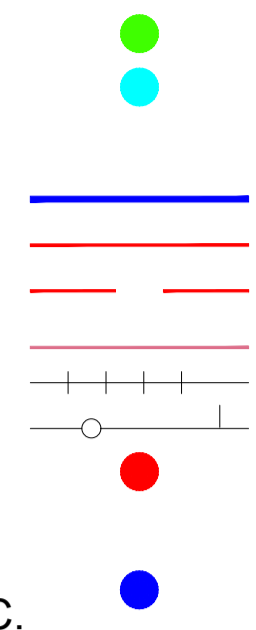

TULLOCH  
GEOMATICS

TCL  
Tunnock Consulting Ltd

