

TOWNSHIP OF PORTER

Zoning Bylaw for the CORPORATION OF THE TOWNSHIP OF BALDWIN

Schedule 'A' Land Use Plan



SCALE 1:20,000
October 1, 2018

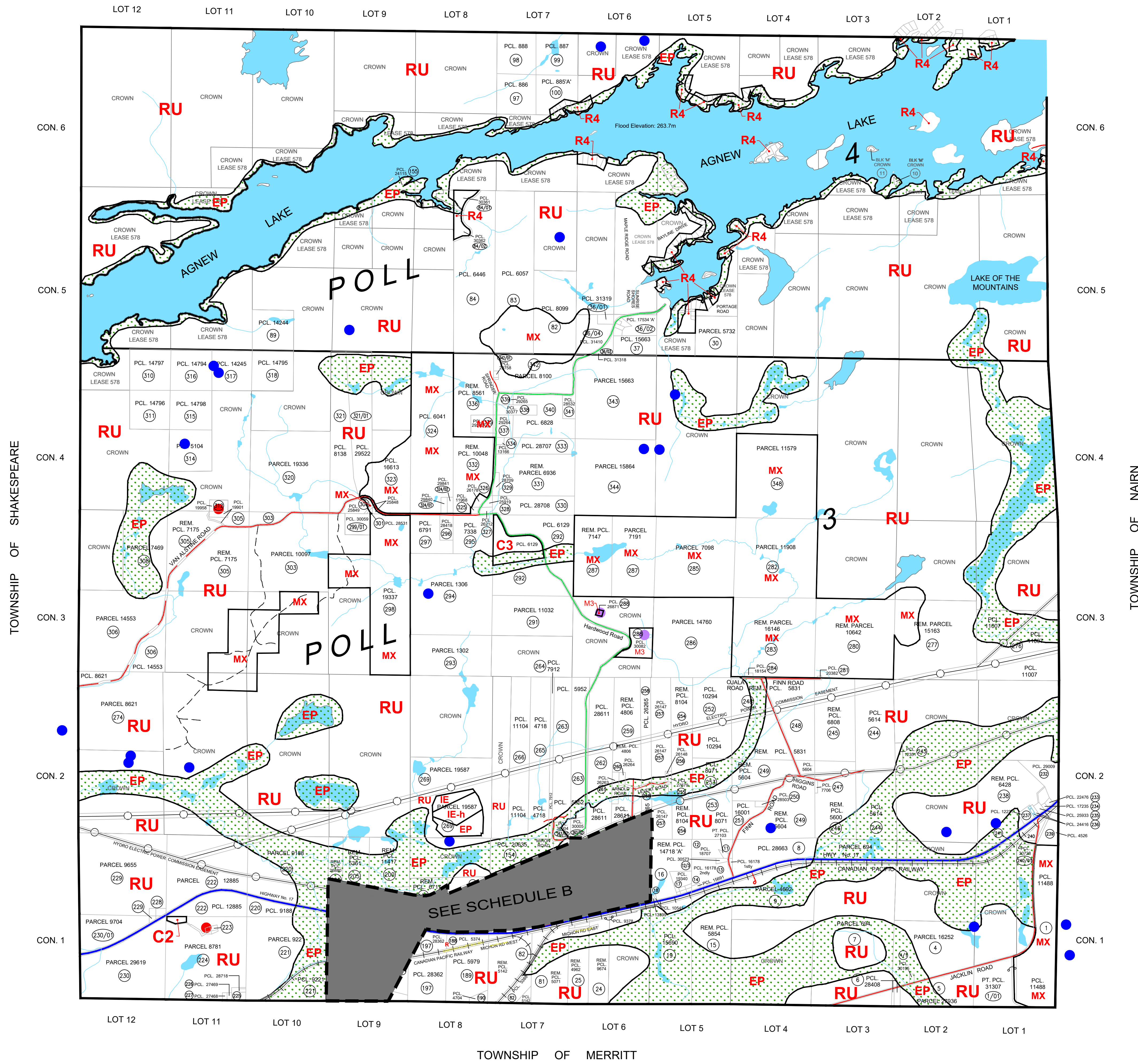
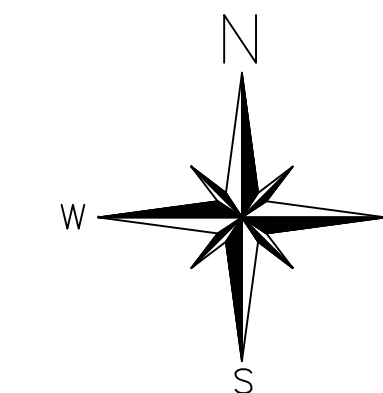

Legend

Residential Zones

- R1 Residential Low Density
- R2 Residential Multiple
- R3 Residential Mobile Home
- R4 Seasonal and Waterfront Residential

Commercial Zones

- C1 General Commercial
- C2 Highway Commercial
- C3 Resort Commercial

Industrial Zones

- M1 Light Industrial
- M2 Rural Industrial
- M3 Waste Management
- MX Aggregate Extractive
- MIN Mining

Other Zones

- RU Rural Zone
- I Institutional
- OS Open Space
- EP Environmental Protection

Community Facilities

- Community/Fire Hall
- Parks and Playgrounds

5. Transportation and Communication

- Provincial Highways
- Township Road
- Township Road (Seasonally Maintained)
- Private Road
- Railway Line
- Hydro Transmission Corridor
- Communication Towers

6. Natural and Human-Made Hazards

- Mine Hazard
- Flood Elevation - Agnew Lake - 263.7m G.S.C.

Digital Mapping Provided By:
Tulloch Geomatics
Elliot Lake, Ontario

Tunnock Consulting Ltd

Zoning Bylaw for the CORPORATION OF THE TOWNSHIP OF BALDWIN

Schedule 'B' Land Use Plan



SCALE
1:5000
0 0.5 1.0 km
October 1, 2018

Legend

Residential Zones

- R1 Residential Low Density
- R2 Residential Multiple
- R3 Residential Mobile Home
- R4 Seasonal and Waterfront Residential

Commercial Zones

- C1 General Commercial
- C2 Highway Commercial
- C3 Resort Commercial

Industrial Zones

- M1 Light Industrial
- M2 Rural Industrial
- M3 Waste Management
- MX Aggregate Extractive
- MIN Mining

Other Zones

- R Rural Zone
- I Institutional
- OS Open Space
- EP Environmental Protection

Community Facilities

- Community/Fire Hall
- Parks and Playgrounds
- 5. Transportation and Communication
- Provincial Highways
- Township Road
- Township Road (Seasonally Maintained)
- Private Road
- Railway Line
- Hydro Transmission Corridor
- Communication Towers

6. Natural and Human-Made Hazards

- Mine Hazard
- Flood Elevation - Agnew Lake - 263.7m G.S.C.

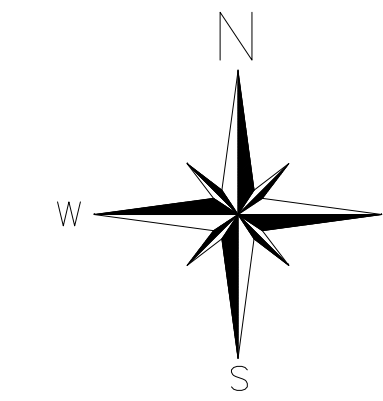
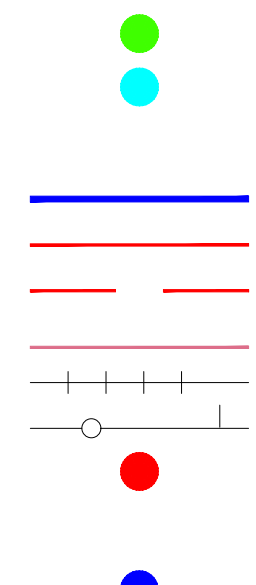

TULLOCH
GEOMATICS

TCL
Tunnock Consulting Ltd

